

TITAN CANTILEVER METAL GATES

EACH GATE WEIGHT MAX 1000kg

APPLICATION

- ▶ Titan is a high quality, robust and heavy duty cantilever gear for sliding metal gates.
- ▶ Titan is suitable for industrial and commercial use.
- ▶ It is ideal for security and traffic control .
- ▶ It can be used where the road surface is uneven or where the roadway has to be free of rails and channels as there is no track on the ground.
- ▶ Due to its construction Titan offers security and maximum weather protection as the rollers are located internally within the track.

GATE SPECIFICATION

- ▶ **Max Gate Width** 10m (excluding overhang)
- ▶ **Max Gate Weight** 1000kg
- ▶ Gates should be fabricated from welded steel section.
- ▶ Track should be welded to the bottom rail of the gate.
- ▶ Side clearance should be great enough to allow for the clear opening width plus the required overhang length of the gate (refer to chart)
- ▶ Rollers should be mounted on substantial concrete footings minimum width of 500mm and depth of 800mm.

GEAR SPECIFICATION

| | |
|-----------------------------|---|
| Track | 700 (4.5mm thickness) or 710 (6.7mm thickness) |
| Material | Steel Zinc plated, standard length 6m |
| Bottom Rollers (2 per gate) | 704, 706, 714, 708, 718 or 720 (refer to table below) |
| End Guide (2 per gate) | 702 or 712 (refer to table overleaf) |
| End Rollers (2 per gate) | 701 or 705 (refer to table overleaf) |
| Top Guide (2 per gate) | 703 side wall (screwed) or 703c side wall (concrete) |



HOW TO CHOOSE YOUR TITAN GATE GEAR

Planning the construction of your Titan cantilever gate:

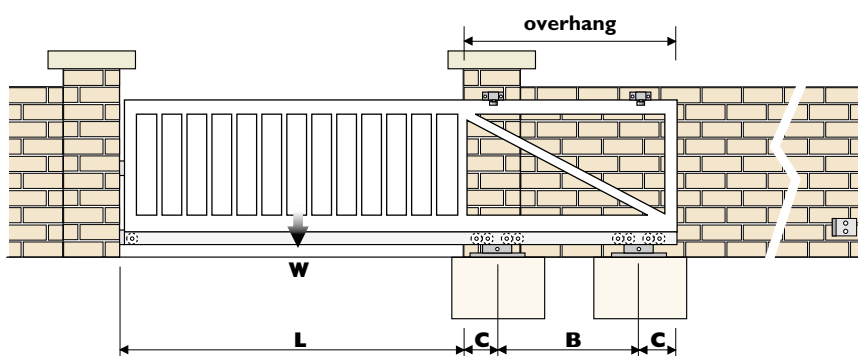

Min. weight of each concrete block for each roller = $1.7 \times W$ (total gate weight with the track)
(average concrete density : 2.6 to 2.8 kg/m³)

B (Distance between roller centres) = $0.3 \times L$

C = Distance from centre of roller to gate overhang, on each side in metres

Read across the chart to your required gate opening width, then read downward to estimate gate weight. Shaded area indicates roller type (refer to colour key) and the overhang length 'C' that is required.

OVERHANG LENGTH 'C' IN METRES SHOWN IN BOXES

| | | Opening Width in Metres | | | | | | | | | |
|-------------------|--------------|-------------------------|-------|-------|-------|-------|-------|-------|-------|-------|-------|
| | | 3.0 | 3.5 | 4.0 | 4.5 | 5.0 | 6.0 | 7.0 | 8.0 | 9.0 | 10.0 |
| Gate Weight in kg | Up to 250kg | 0.235 | 0.235 | 0.235 | 0.235 | 0.235 | 0.235 | | | | |
| | Up to 550kg | 0.345 | 0.345 | 0.345 | 0.345 | 0.345 | 0.345 | 0.345 | 0.345 | 0.410 | 0.410 |
| | Up to 1000kg | 0.410 | 0.410 | 0.410 | 0.410 | 0.410 | 0.410 | 0.410 | 0.410 | 0.410 | 0.410 |

- Use a pair of rollers 704 and track 700 with end rollers 701 and end guide 702.
- Use a pair of rollers 708 and track 700, with end rollers 701 and end guide 702
- Use a pair of rollers 718 and track 710 with end rollers 705 and end guide 712.

Note: To automate your Titan cantilever gate all figures and dimensions remain the same.

TITAN CANTILEVER METAL GATES

| STEEL TRACK | | | | | | | |
|-------------|------------------|--------|-----------|----|-----|----|-----|
| Part No. | Material | Length | Weight kg | L | H | O | T |
| 700 | Galvanised Steel | 6m | 75 | 80 | 75 | 22 | 4.5 |
| 710 | Galvanised Steel | 6m | 96 | 90 | 110 | 25 | 6.5 |

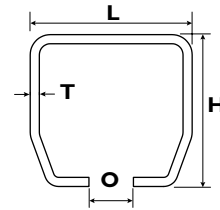

| HANGERS WITH GUIDING WHEEL | | | | | | | | |
|----------------------------|-----|-----|-----|-----|-----|-----|-----|-----|
| Part No. | L | H | I | R | A | B | C | D |
| 704 | 209 | 141 | 130 | 83 | 130 | 170 | 90 | 135 |
| 708 | 430 | 145 | 150 | 83 | 150 | 200 | 110 | 165 |
| 718 | 560 | 196 | 200 | 103 | 200 | 300 | 160 | 260 |

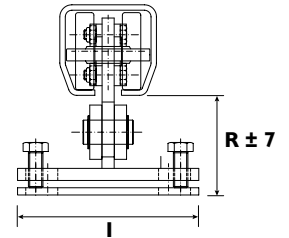
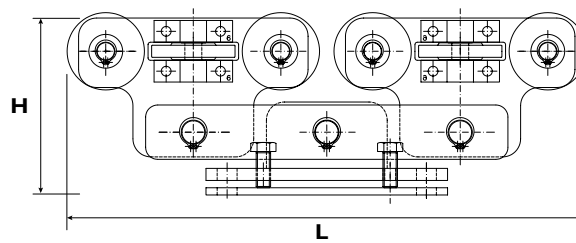
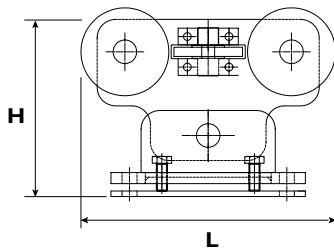

| Part No. | Designation |
|----------|---------------------------------|
| 702 | End guide for track 700 |
| 712 | End guide for track 710 |
| 701 | End wheel support for track 700 |
| 705 | End wheel support for track 710 |

